

Sold

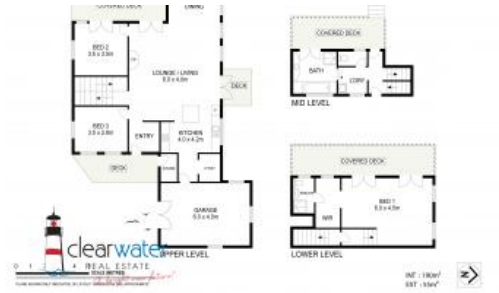

## 8 Whiffens Lane, Central Tilba



### Living The Dream in Central Tilba

"Avaline" - Situated in the historic village of Central Tilba is this multi level family home in - very good condition. Light bright and airy rooms, timber floors throughout, undercover decks, garage and carport. The spacious decks allow for entertaining or just sitting back and enjoying the view over the garden and magnificent native gum tree.

Upper Level: from the time you step into the entry foyer/boot room, you will notice the quality and presentation of this home. Open plan living dining and kitchen with walk in pantry and access to the upper covered deck. There is a also a smaller north facing deck which is ideal for your morning cuppa. A slow combustion fire heats this area in the cooler months. On this floor are two bedrooms, one with access to the covered deck.

Middle level: The family bathroom is conveniently located on this level along with the laundry, separate toilet and access to the covered deck.

Lower Level: A very large master bedroom, ensuite, walk in robe and space for a lounge and/or an office desk. A great feature of the master bedroom is the private lower covered deck.

Garage: With access to the main house, this would be an ideal space for a teenage retreat or home office.

Location: A short walk to the main street of Central Tilba, a short drive to Mystery Bay and its pristine beaches. Bermagui & Narooma are only a short drive away. Central Tilba has many curiosity shops, post office, fuel, Bates General Store, historic B & B accommodation, cafe's, Dromedary Hotel, cheese factory, primary school, plus much more.

3 Bedrooms 2 Bathrooms 2 Carports 993 m2

**Price** SOLD for \$638,000  
**Property Type** Residential  
**Property ID** 379  
**Land Area** 993 m2

#### Agent Details

Sam Sheather - 0478 004 088

#### Office Details

Clearwater Real Estate - Narooma  
 02 4476 4449



The above information provided has been furnished to us by the vendor/s. We have not verified whether or not that information is accurate and do not have any belief in one way or the other in its accuracy. We do not accept any responsibility to any person for its accuracy and do no more than pass it on. All interested parties should make and rely upon their own inquiries in order to determine whether or not this information is in fact accurate.